

## TRIANGLE

### INSTALLATION INSTRUCTIONS

These installation suggestions consist of a common process for TRIANGLE installation. Installers should rely upon their own professional experience and understanding of their unique requirements to ensure a successful install.

#### Tools Needed



Drill



Putty Knife



Construction Adhesive



Liquid Nail



Box Cutter

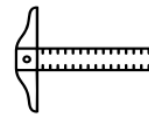

Straight Edge

#### Items Included

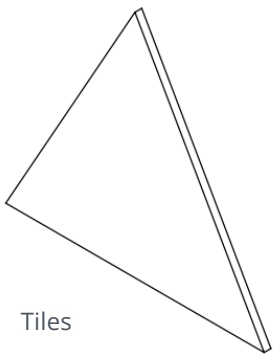

Tiles

- 1 Unwrap tiles from plastic wrap. Confirm tile dimensions match your needs.

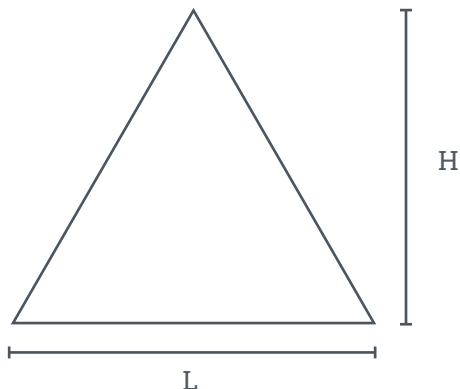

# TRIANGLE

## INSTALLATION INSTRUCTIONS

- 2 Measure the length and height of the wall. Find center of the wall.

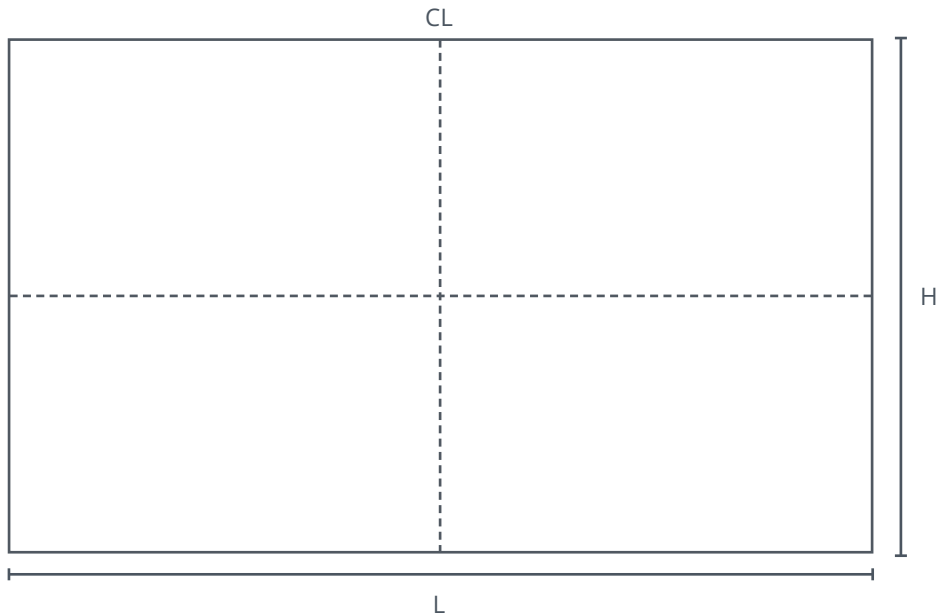

- 3 Lay the tile on the ground and use the putty knife to place the carpet glue to one TRIANGLE tile at a time, or use Liquid Nail. The adhesive has 20-25 minutes of drying time.

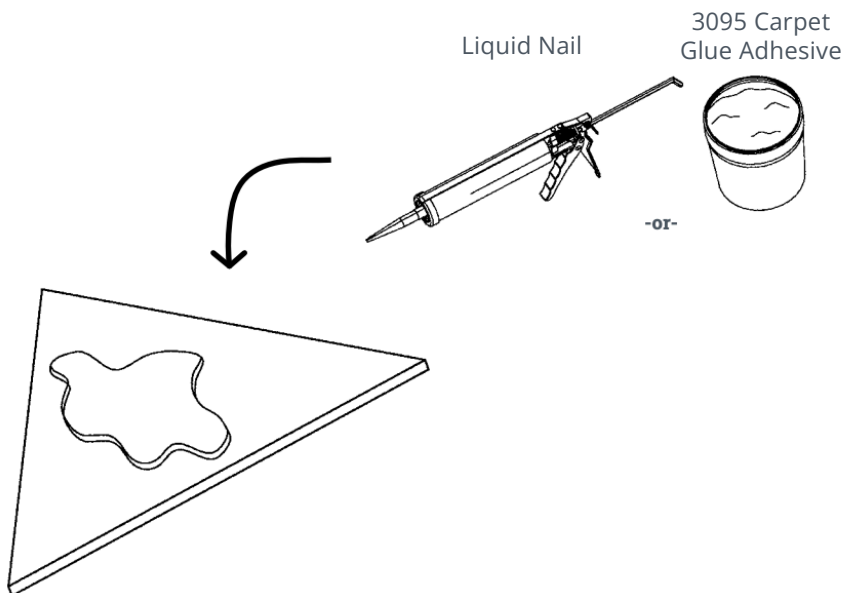

# TRIANGLE

## INSTALLATION INSTRUCTIONS

- 4 Position the tile on the wall.

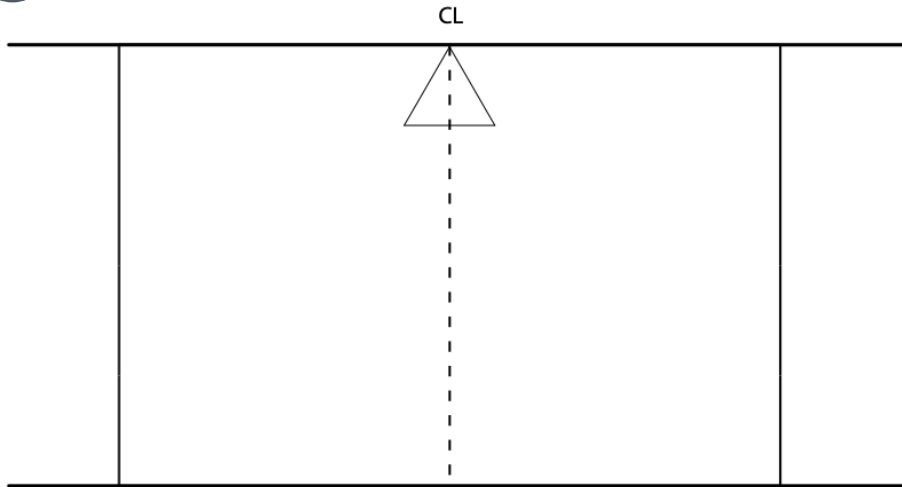

- 5 Use a box cutter and metal ruler to cut off the excess material to fit on the wall.

**Tip for clean edges:** Use smooth continuous motion to cut through half the thickness of the material; using the edge of the ruler as your guide. Go over the same line again to complete the cut.

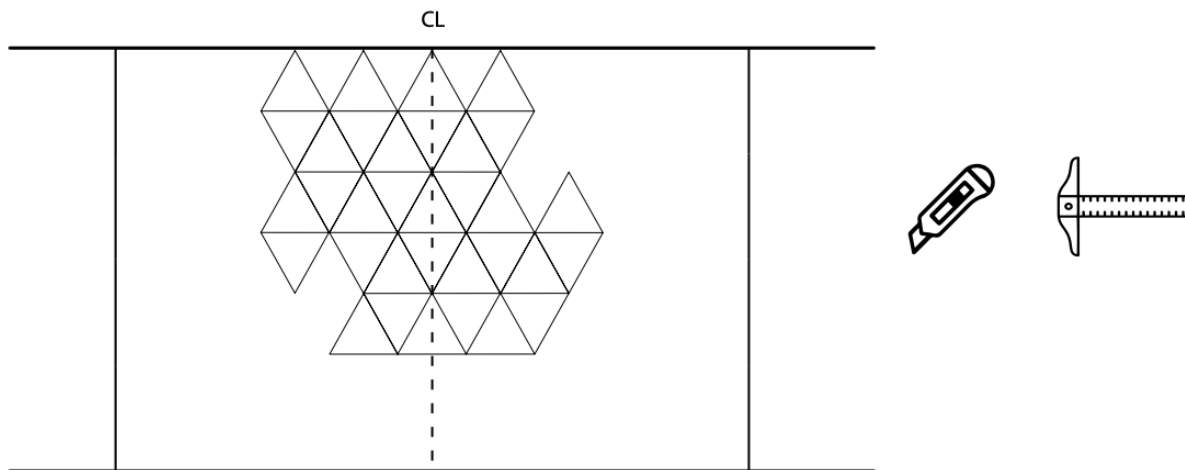

- 6 Layout desired pattern on wall to complete the installation.

INSTALLATION COMPLETE